

VERSION	CHANGE CONTENT	DATE
V00	FIRST	2009-09-08
V01	CHANGE INTERFACE	2010-12-30

TYPE	A	B
LED B/L	12.0	7.5

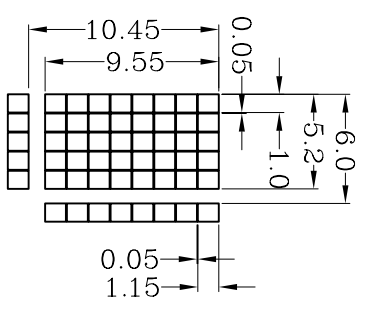
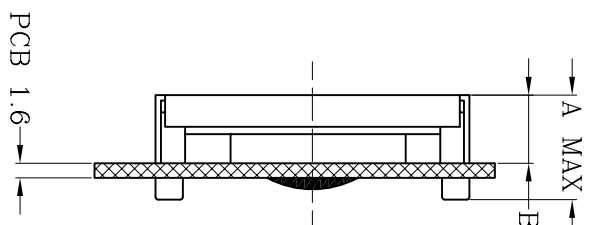
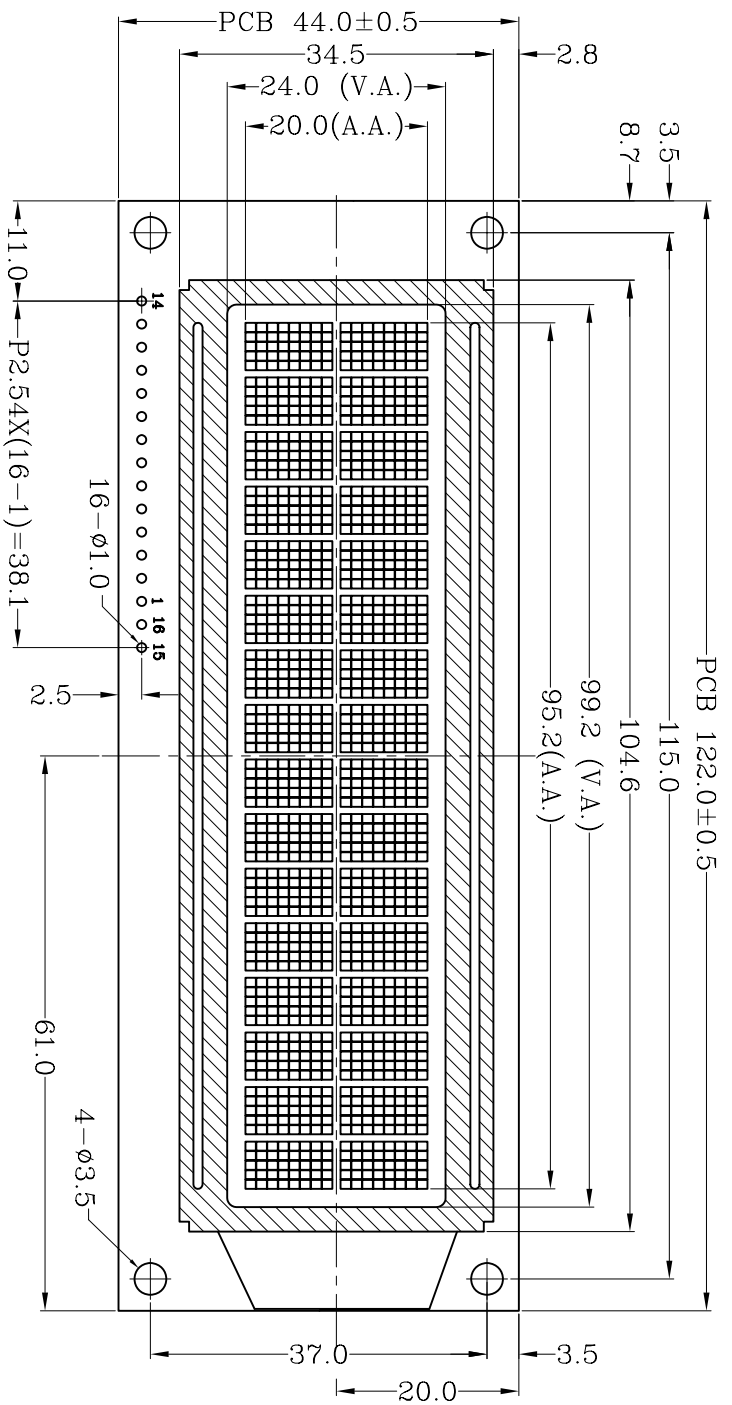

DETAIL DOTS
SCALE: 2:1

PIN	1	2	3	4	5	6	7	8	9	10	11	12	13	14	15	16
NAME	VSS	VDD	VO	RS	R/W	E	DB0	DB1	DB2	DB3	DB4	DB5	DB6	DB7	LED+	LED-



SPECIFICATIONS

1. DISPLAY TYPE: STN / TRANSMISSIVE / NEGATIVE / BLUE
2. LCD DRIVING VOLTAGE: 5.0 V
3. LOGIC VOLTAGE: 5.0 V
4. VIEWING DIRECTION: 6 O'CLOCK
5. OPERATING TEMP.: -20° C ~ 70° C
6. STORAGE TEMP.: -30° C ~ 80° C
7. DRIVE MODE: 1 / 16 DUTY, 1 / 5 BIAS
8. BACKLIGHT: WHITE / SIDE / BACKLIGHT / 5.0 V
9. OTHER: MECHANICAL TOL. ±0.3 UNLESS SPECIFIED

NOTE:

DESCRIPTION:

C/D

SCALE: FIT

SHEET: 1 OF 1



INDUSTRIAL CO., LTD.

TINSHARP

SERIAL NUMBER

UNIT: mm

MODEL
TC1602D-02T

MLX1522

APP:

CHK:

DWN:

DATE:

DATE:

DATE: